

# 7

## IEC and British Standard fuses

NH HRC fuses

### NHG B

#### Specifications

**Class:** gG/gL

**Description:** DIN square bodied, dual indication industrial fuses.

**Construction:** Steatite insulator, corrosion-proof (aluminum) metal parts with full-contact, silver-plated copper blades.

**Sizes:** DIN 000 to 4.

**Selectivity ratio:** 1:1.6 up to 500Vac.



#### Ratings:

Volts: — 500Vac

— 690Vac

Amps: — 2-1250A

IR: — 120kA

Frequency: — 50Hz

Operating frequency: — 45-62Hz

**Agency information:** IEC 60269, VDE 0636, DIN 43620 Part 1 to 4, VDE Mark and CE.

Fuse blocks	Size
SD00-D	000-00
SD1-D	1*, 1
SD2-D	02, 2, 03, 3

#### Dimensions - mm

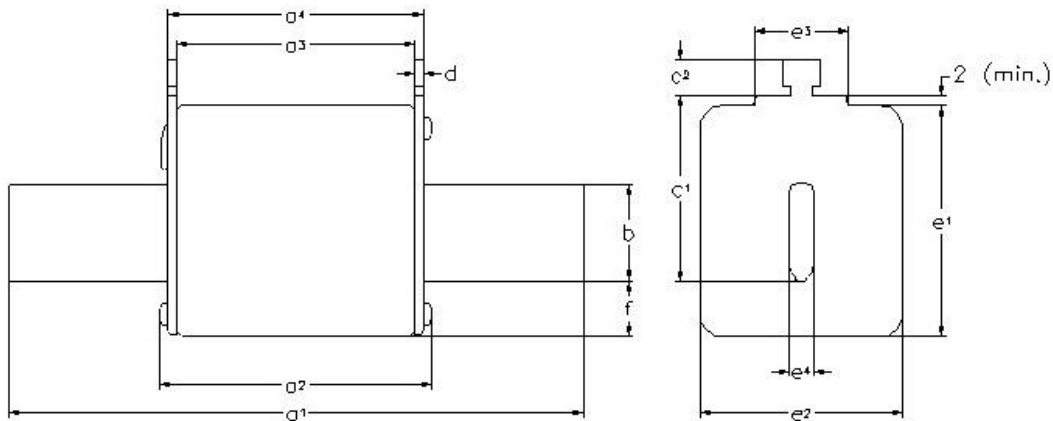

Fuse size	a <sup>1</sup>	a <sup>2</sup> (max)	a <sup>3</sup>	a <sup>4</sup>	b (nom)	c <sup>1</sup> (± 8)	c <sup>2</sup> (nom)	D (nom)	e <sup>1</sup> (max)	e <sup>2</sup> (max)	e <sup>3</sup> (max)	e <sup>4</sup> (nom)	f (max)
000	78.5 ± 1.5	54	45 ± 1.5	49 ± 1.5	15	35	10	2 ± 0.5	41	21	16	6	8
00	78.5 ± 1.5	54	45 ± 1.5	49 ± 1.5	15	35	11	7.0 ± 0.5	48	30	25	6	15
0	125 ± 2.5	68	62 +3/-1.5	68 +1.5/-3	15	35	11	2.5 ± 0.5	48	30	25	6	15
01	135 ± 2.5	75	62 ± 2.5	68 ± 2.5	15	40	11	2.5 ± 0.5	48	30	25	6	15
1	135 ± 2.5	75	62 ± 2.5	68 ± 2.5	20	40	11	2.5 ± 0.5	53	52	25	6	15
02	150 ± 2.5	75	62 ± 2.5	68 ± 2.5	20	48	11	2.5 ± 0.5	53	52	25	6	15
2	150 ± 2.5	75	62 ± 2.5	68 ± 2.5	25	48	11	2.5 ± 0.5	61	60	25	6	15
03	150 ± 3	75	62 ± 2.5	68 ± 2.5	25	60	11	2.5 ± 0.5	61	60	25	6	15
3	150 ± 3	75	62 ± 2.5	68 ± 2.5	32	60	11	3.0 ± 0.5	75	70	25	6	18
4	200	84	80	90	50	85	11	3	120	87	—	8	30



Data Sheet 10164

# IEC and British Standard fuses

## NH HRC fuses

500Vac	Size	Rated current (amps)	gG/gL dual indicator voltage conducting metal gripping lugs	Carton quantity
	000	2	2NHG000B	3
		4	4NHG000B	3
		6	6NHG000B	3
		10	10NHG000B	3
		16	16NHG000B	3
		20	20NHG000B	3
		25	25NHG000B	3
		32	32NHG000B	3
		35	35NHG000B	3
		40	40NHG000B	3
		50	50NHG000B	3
		63	63NHG000B	3
		80	80NHG000B	3
		100	100NHG000B	3
		50	50NHG00B	3
		63	63NHG00B	3
80	80NHG00B	3		
100	100NHG00B	3		
125	125NHG00B	3		
160	160NHG00B	3		
	0	6	6NHGOB	3
		10	10NHGOB	3
		16	16NHGOB	3
		20	20NHGOB	3
		25	25NHGOB	3
		32	32NHGOB	3
		35	35NHGOB	3
		40	40NHGOB	3
		50	50NHGOB	3
		63	63NHGOB	3
80	80NHGOB	3		
100	100NHGOB	3		
125	125NHGOB	3		
160	160NHGOB	3		
	01	6	6NHG01B	3
		10	10NHG01B	3
		16	16NHG01B	3
		20	20NHG01B	3
		25	25NHG01B	3
		32	32NHG01B	3
		35	35NHG01B	3
		40	40NHG01B	3
		50	50NHG01B	3
		63	63NHG01B	3
		80	80NHG01B	3
		100	100NHG01B	3
		125	125NHG01B	3
		160	160NHG01B	3

500Vac	Size	Rated current (amps)	gG/gL dual indicator voltage conducting metal gripping lugs	Carton quantity
	1	50	50NHG1B	3
		63	63NHG1B	3
		80	80NHG1B	3
		100	100NHG1B	3
		125	125NHG1B	3
		160	160NHG1B	3
		200	200NHG1B	3
		224	224NHG1B	3
		250	250NHG1B	3
		315	315NHG1B	3
		355	355NHG1B	3
		35	35NHG02B	3
	40	40NHG02B	3	
	50	50NHG02B	3	
	63	63NHG02B	3	
	80	80NHG02B	3	
	100	100NHG02B	3	
	125	125NHG02B	3	
	160	160NHG02B	3	
	200	200NHG02B	3	
	224	224NHG02B	3	
	250	250NHG02B	3	
	250	250NHG2B	3	
	300	300NHG2B	3	
315	315NHG2B	3		
355	355NHG2B	3		
400	400NHG2B	3		
425	425NHG2B	3		
450	450NHG2B	3		
500	500NHG2B	3		
250	250NHG03B	3		
315	315NHG03B	3		
355	355NHG03B	3		
400	400NHG03B	3		
315	315NHG3B	3		
355	355NHG3B	3		
400	400NHG3B	3		
425	425NHG3B	3		
450	450NHG3B	3		
500	500NHG3B	3		
630	630NHG3B	3		
800	800NHG3B	3		
500	500NHG4G	1		
630	630NHG4G	1		
800	800NHG4G	1		
1000	1000NHG4G	1		
1250	1250NHG4G	1		

\* Size 4 is for a fuse with a single indicator link with slotted end tags.

# 7

## IEC and British Standard fuses

NH HRC fuses

690Vac	Size	Rated current (amps)	gG/gL dual indicator voltage conducting metal gripping lugs	Carton quantity	
	000	2	2NHG000B-690	3	
		4	4NHG000B-690	3	
		6	6NHG000B-690	3	
		10	10NHG000B-690	3	
		16	16NHG000B-690	3	
		20	20NHG000B-690	3	
		25	25NHG000B-690	3	
		32	32NHG000B-690	3	
		35	35NHG000B-690	3	
		40	40NHG000B-690	3	
		50	50NHG000B-690	3	
		63	63NHG000B-690	3	
		00	50	50NHG00B-690	3
			63	63NHG00B-690	3
			80	80NHG00B-690	3
			100	100NHG00B-690	3
125	125NHG00B-690		3		
1	160*	160NHG00B-690	3		
	50	50NHG1B-690	3		
	63	63NHG1B-690	3		
	80	80NHG1B-690	3		
	100	100NHG1B-690	3		
	125	125NHG1B-690	3		
	160	160NHG1B-690	3		
	200	200NHG1B-690	3		
2	224	224NHG1B-690	3		
	250	250NHG1B-690	3		
	200	200NHG2B-690	3		
	224	224NHG2B-690	3		
	250	250NHG2B-690	3		
3	315	315NHG2B-690	3		
	250	250NHG3B-690	3		
	315	315NHG3B-690	3		
	355	355NHG3B-690	3		
	400	400NHG3B-690	3		
	425	425NHG3B-690	3		
4	500	500NHG3B-690	3		
	630	630NHG4B-690	1		
	800	800NHG4B-690	1		

\* 160 amps rated at 660Vac.

\*\* Size 4 is for a fuse with a single indicator link with slotted end tags.